

Technics

TAPE DECK

RS-M205

OPERATING INSTRUCTIONS

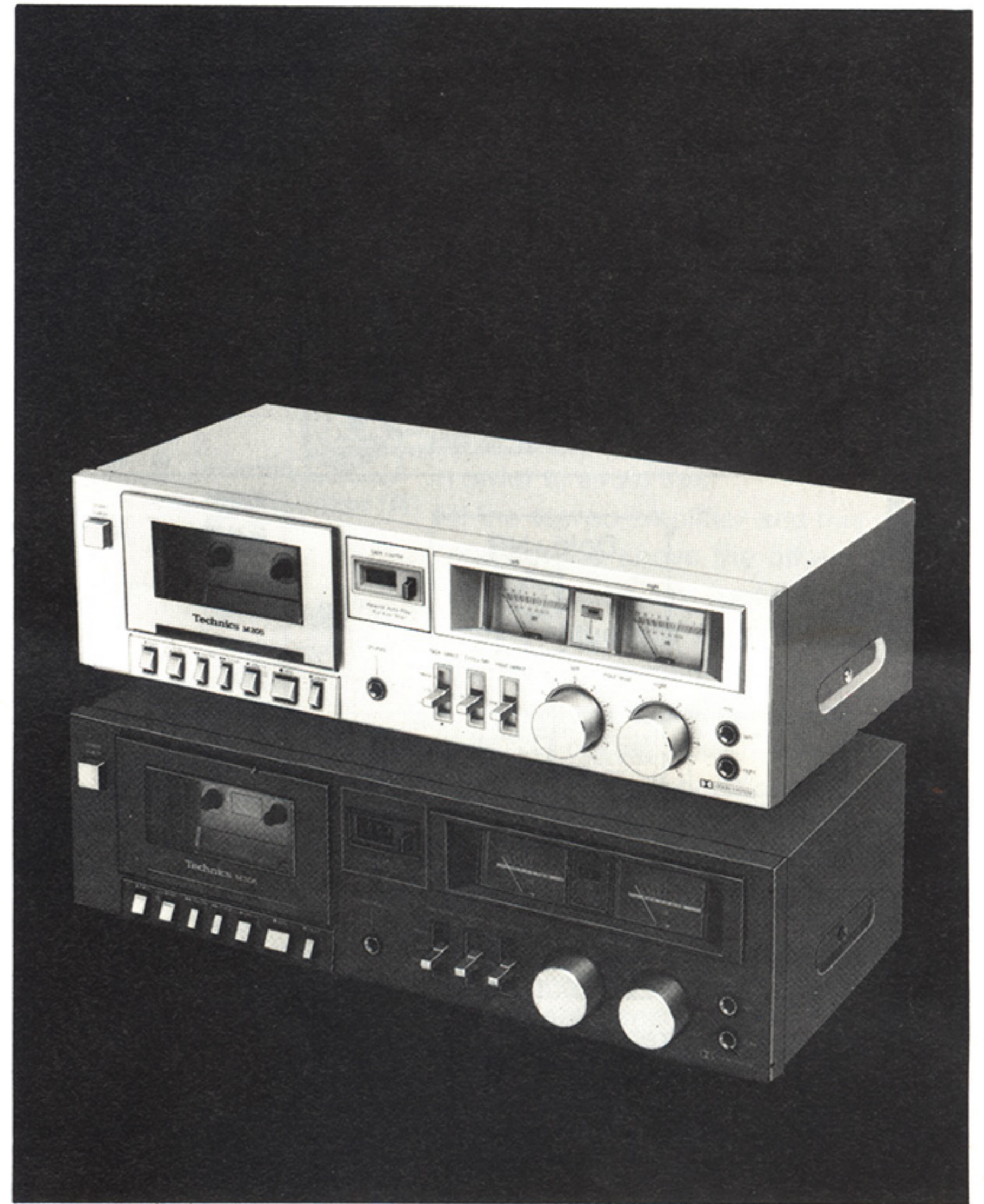

REVINTAGES.COM

CONTROLS

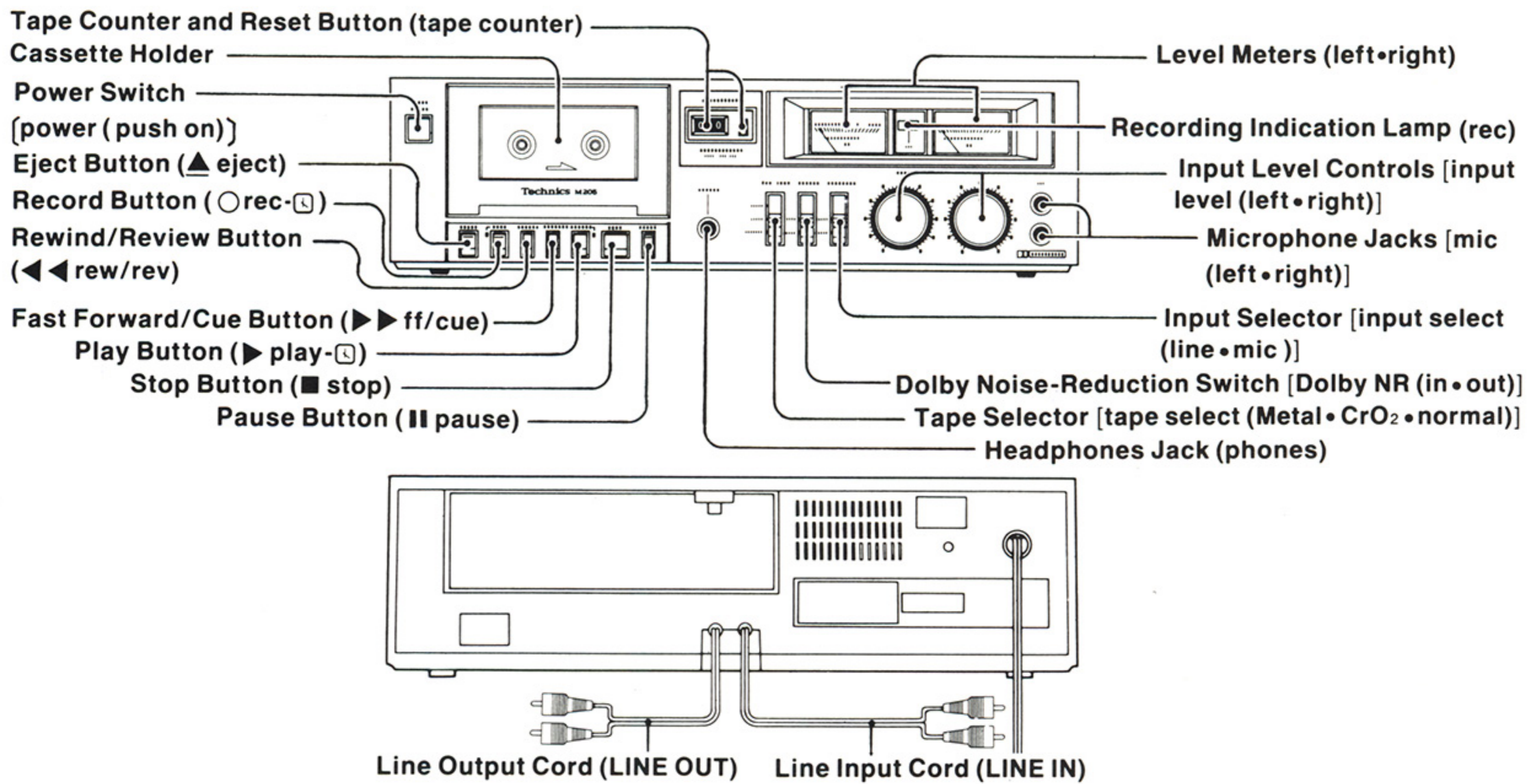

CONNECTIONS

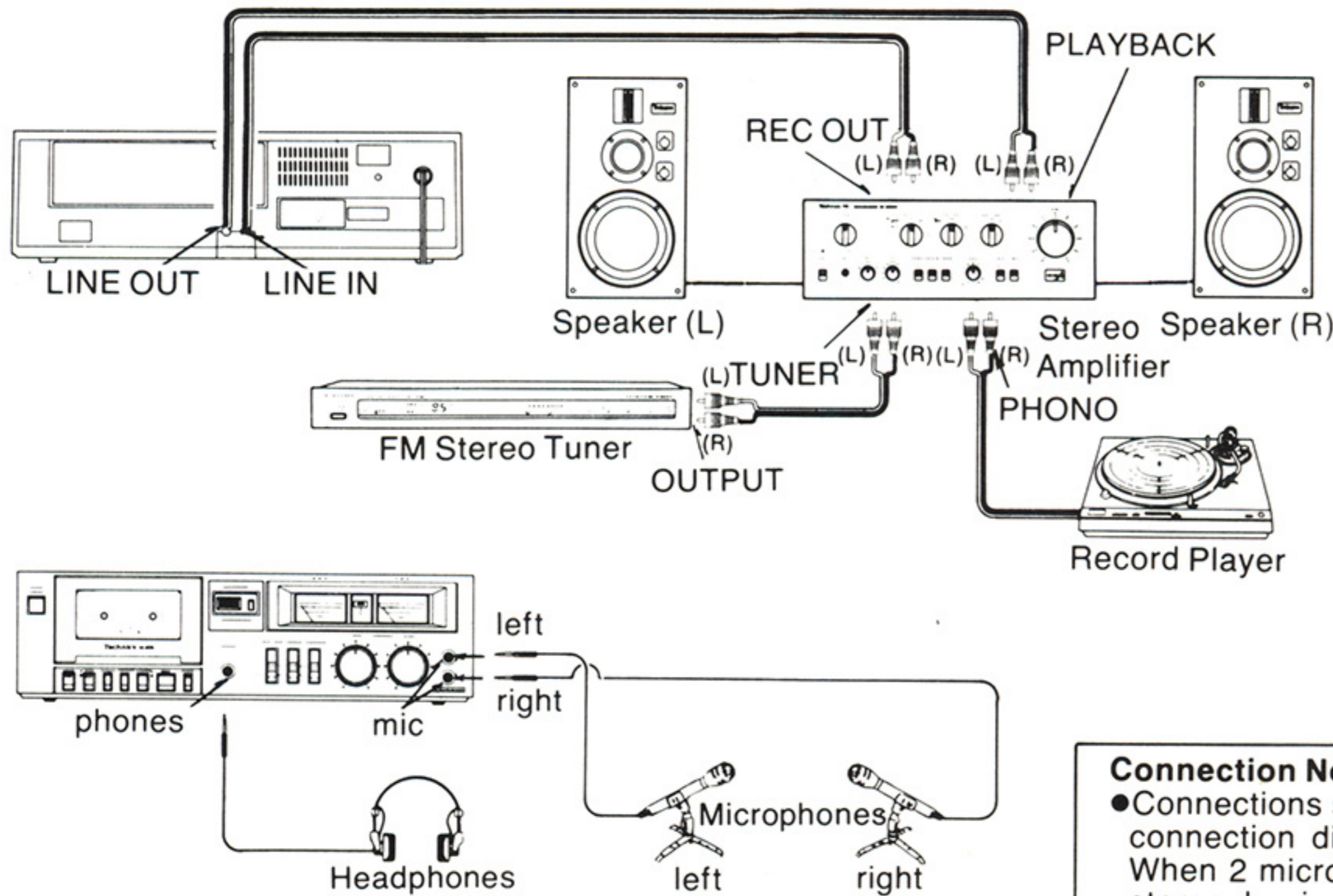

Location of this unit and stereo amplifier

If this unit is placed on top of the stereo amplifier or next to it, a "hum" noise may be heard during tape playback. Refer to the following information below in order to avoid this.

- If the stereo amplifier and this unit are placed one above the other, leave as much space as possible between them, and place them where there is the least amount of hum.
- If the stereo amplifier and this unit are placed one beside the other, try reversing their positions, and place them where there is the least amount of hum.

Connection Note:

- Connections should be made in accordance with the connection diagram and the following instructions. When 2 microphones are used in order to record in stereophonic sound, be sure both of them have the same specification standards.

TAPE SELECTOR

In order to get the best performance from tape, and to record and playback with minimum distortion, the Tape Selector should be set as follows:

| Tape Selector Setting | Brand | Tape Type |
|-----------------------|-----------------------|------------------|
| Normal | AMPEX GRAND MASTER I | C-60, C-90 |
| | BASF PROFESSIONAL I | C-60, C-90 |
| | FUJI FX I | C-60, C-90 |
| | MAXELL UD | C-60, C-90 |
| | MAXELL UDXLI | C-60, C-90 |
| | SCOTCH MASTER I | C-60, C-90 |
| | SONY UHF | C-60, C-90 |
| | TDK AD | C-60, C-90 |
| CrO ₂ | AMPEX GRAND MASTER II | C-60 |
| | BASF PROFESSIONAL II | C-60 |
| | FUJI FX II | C-60 |
| | MAXELL UDXL II | C-60 |
| | SCOTCH MASTER II | C-60 |
| | TDK SA | C-46, C-60 |
| Metal | FUJI SR | C-46, C-60, C-90 |
| | MAXELL MX | C-46, C-60, C-90 |
| | SCOTCH METAFINE | C-46, C-60, C-90 |
| | SONY METALLIC | C-46, C-60, C-90 |
| | TDK MA | C-46, C-60, C-90 |

Note that there may be a difference in sensitivity of 2 or 3 dB, depending on the type of tape.

CASSETTE INSERTION AND REMOVAL • Follow the numbered order.

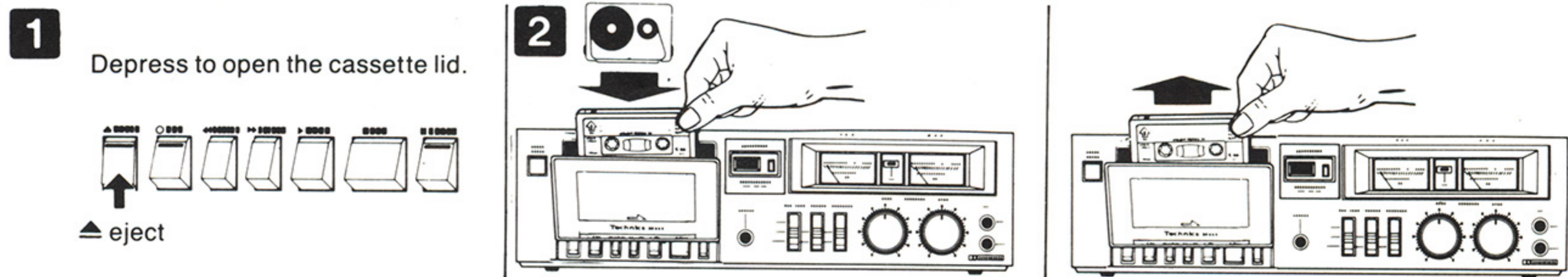

Notes:

- Be sure the open part of the cassette faces downward. If it is upside down, the Cassette Holder can't be closed.
- Be sure to close the Cassette Holder gently.
- Be careful not to press the Eject Button while the tape is moving, because tape movement will stop and the Cassette Holder will open.

OPERATION NOTE

Do not depress the Record or Play Button when no power is supplied to the unit. To do so, even if the Stop Button is depressed afterward, will momentarily cause the tape head assembly to operate when power to the deck is turned on. Do not depress the Record or Play Button immediately after turning off the power of the tape deck. To do so, will keep the

tape head assembly in its normal play position making tape ejection impossible. Switch the power "on" again to eject the tape. This is normal operation for our decks employing the new soft-touch tape transport controls and in no way is detrimental to the tape deck or tape.

PLAYBACK • Follow the numbered order.

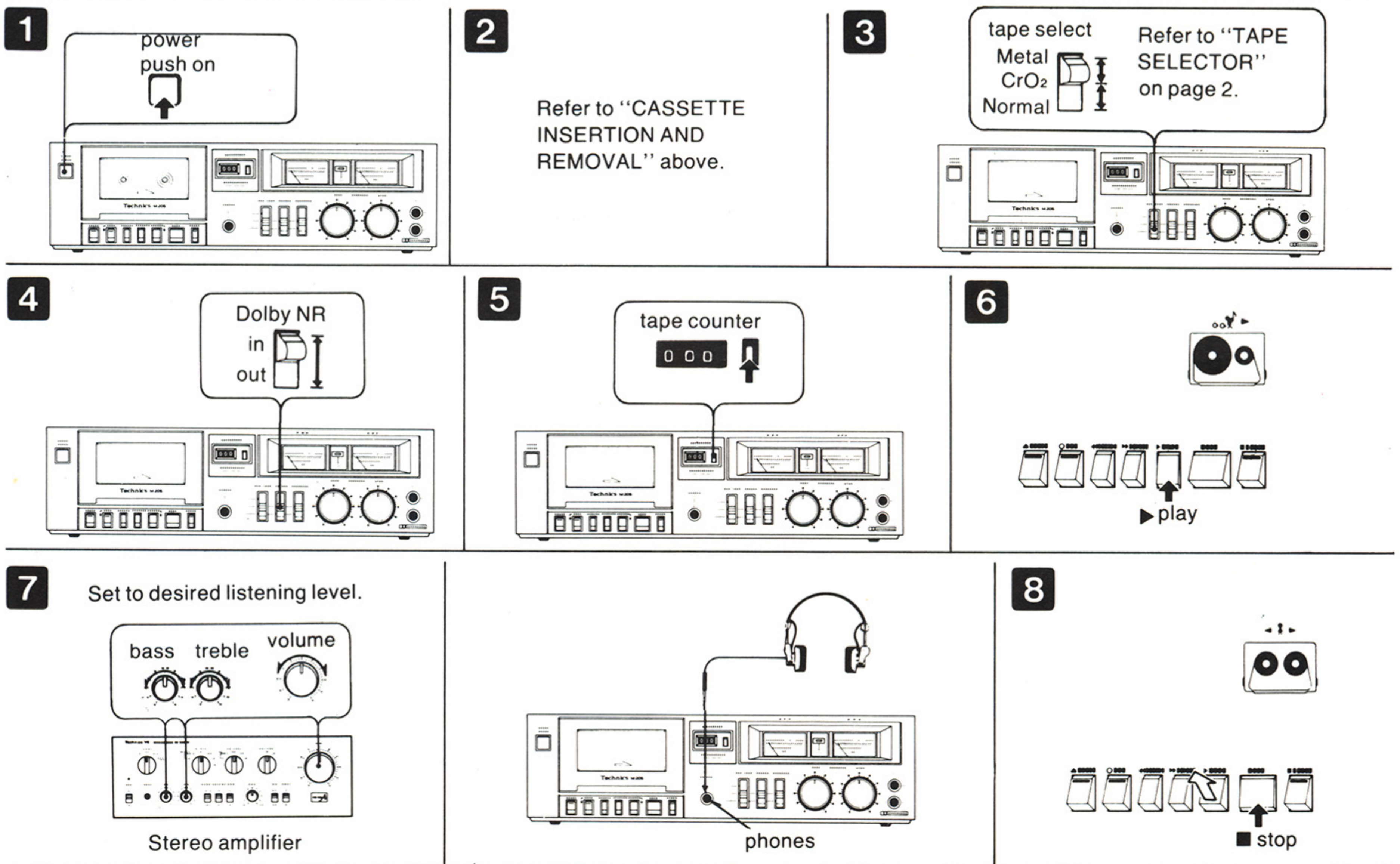

Notes:

- Note that the operation buttons will not function until about 5 seconds have passed after the power is turned on.
- Set the Dolby Noise Reduction Switch to the "in" position when recording or playing back with the Dolby system.

FAST FORWARD AND REWIND • Follow the numbered order.

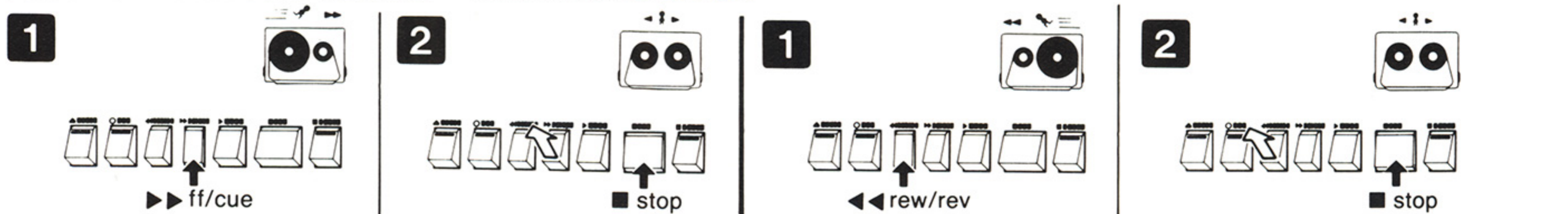

Caution:

Do not push the Eject Button during the fast forward or the rewind operation. Before pushing the Eject Button, be sure to first stop the tape by pushing the Stop Button.

CUE AND REVIEW

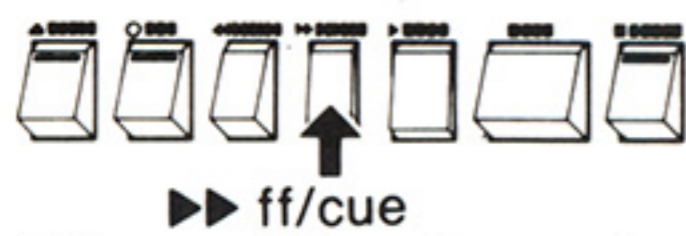

▶▶ ff/cue

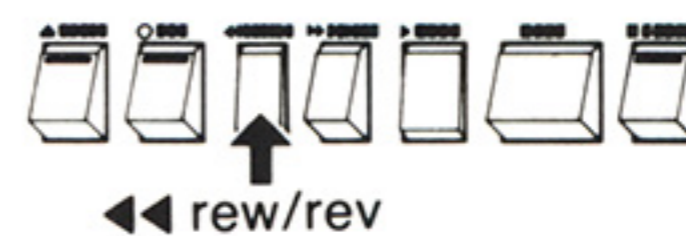

◀◀ rew/rev



When the Fast Forward/Cue Button (or Rewind/Review Button) is pushed during playback, the playback sound can be monitored (although garbled) through the speaker as the tape is either rewound or fast forwarded.

Note: Reduce the volume level of the stereo amplifier before performing the "cue" or "review" operation. If the volume is too high, the tweeters in the speaker systems may be damaged.

REWIND AUTO PLAYBACK • Follow the numbered order.

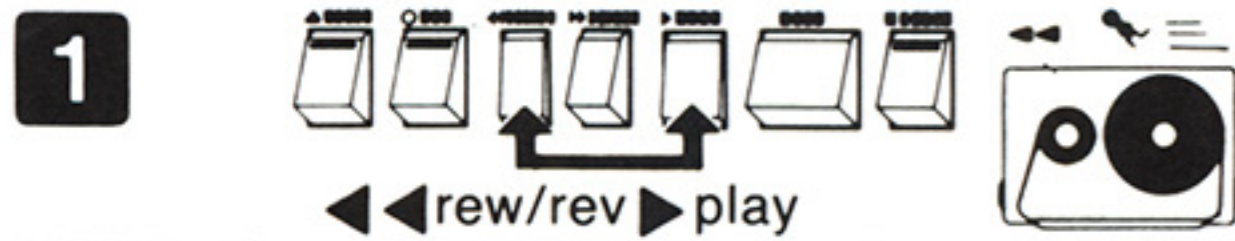

To playback the tape again after recording or playback is completed, push the Play Button and the Rewind/Review Button at the same time.

The tape will be rewound to its beginning and playback will begin automatically.

RECORDING • Follow the numbered order.

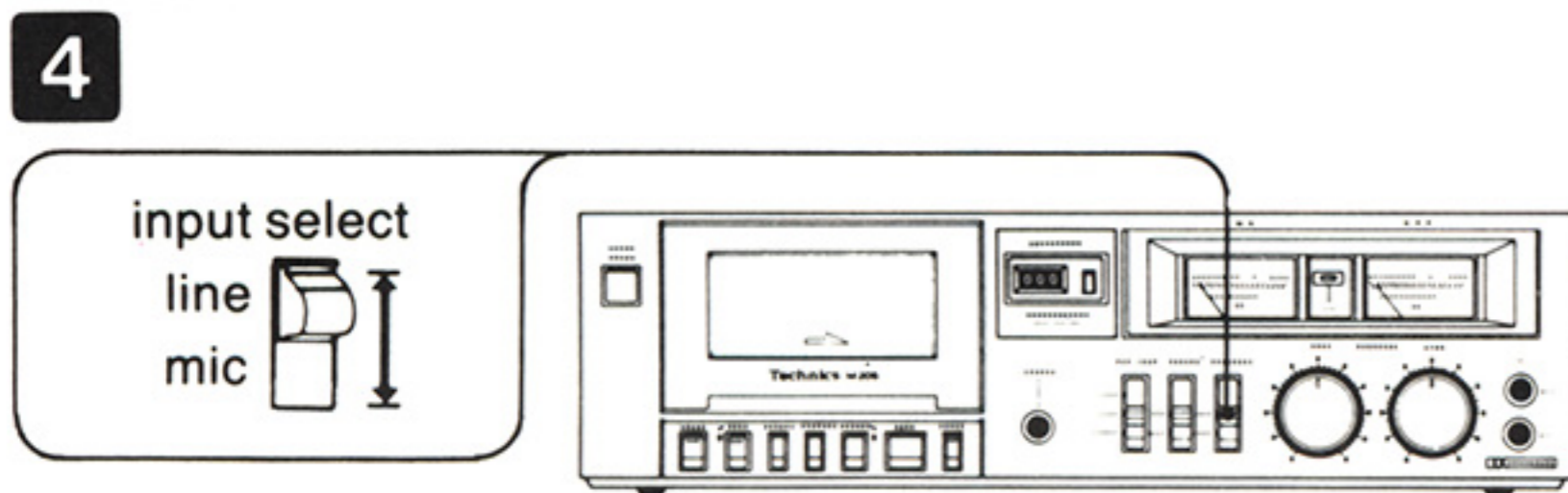
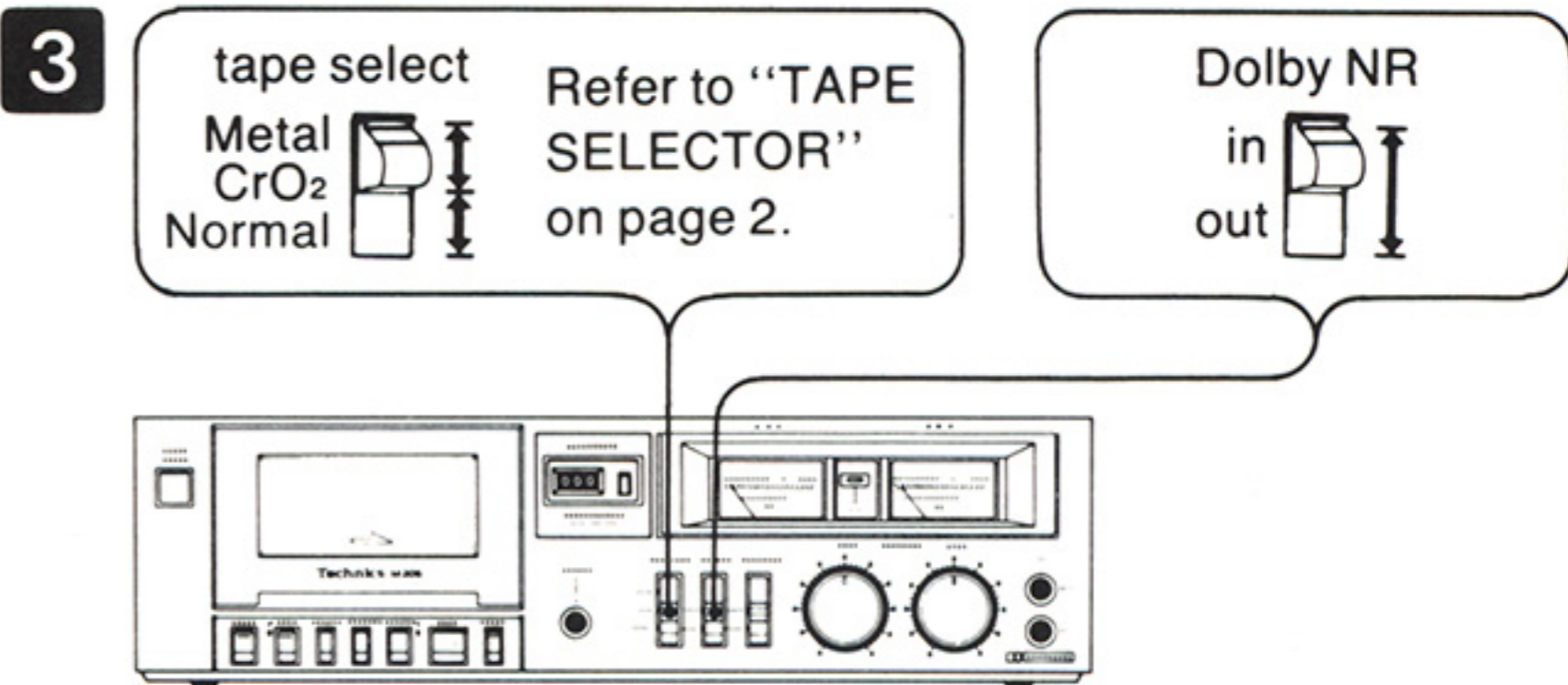
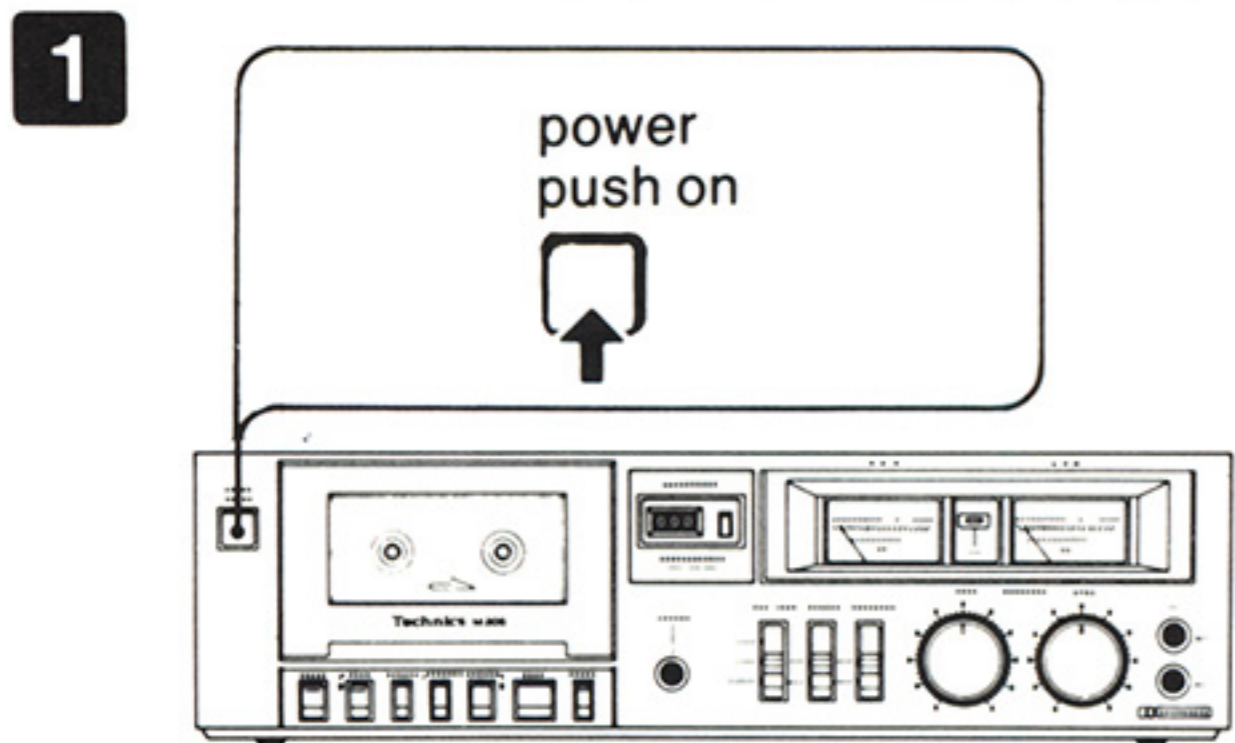

If the recording is to be made by microphone(s), set the Input Selector to the "mic" position. If the recording is to be made from equipment connected to the Line Input cord, set the Input Selector to the "line" position.

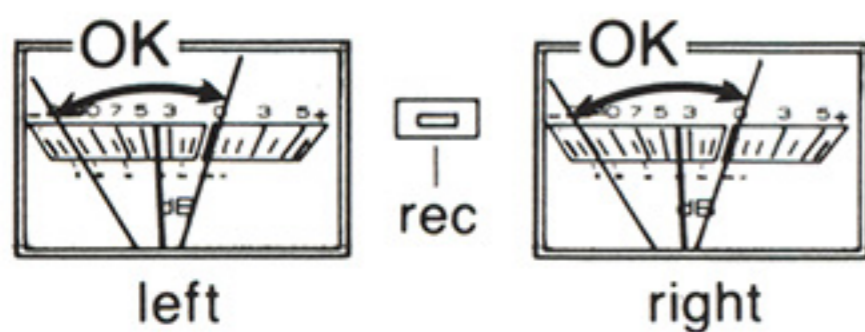
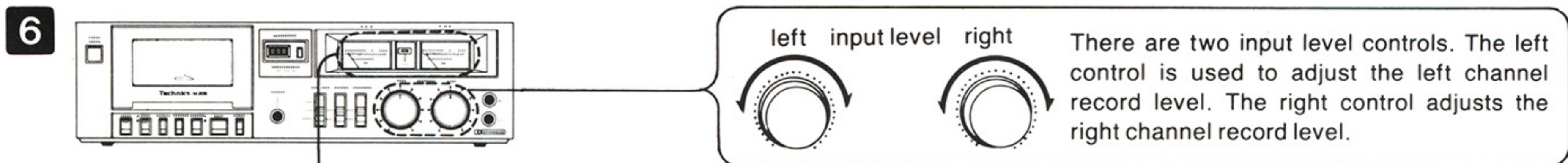
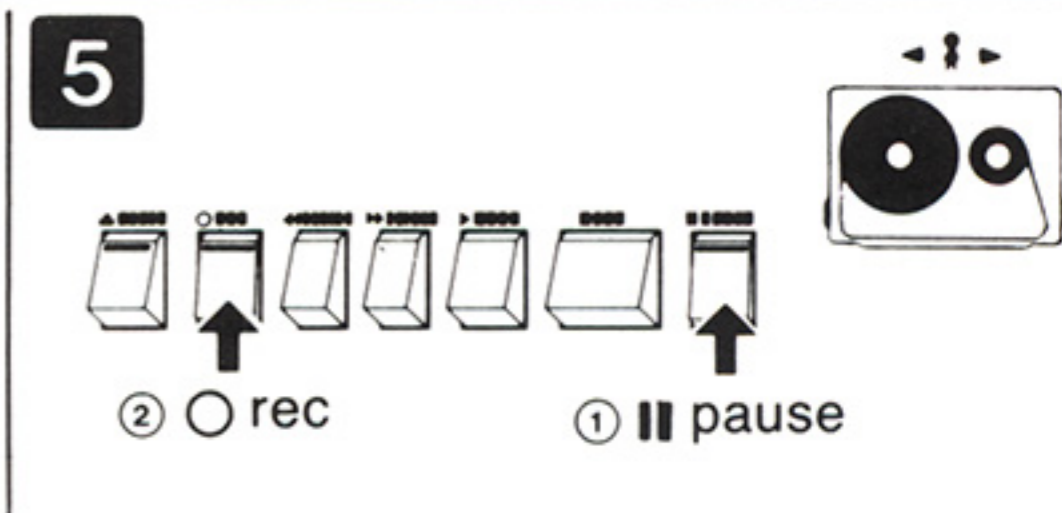

Adjust so that the indication needles do not cross the "0" position even when recording loud sounds, but so that they fluctuate as closely to "0" (without crossing it) as possible.
(There will be no problem if they cross over "0" momentarily.)

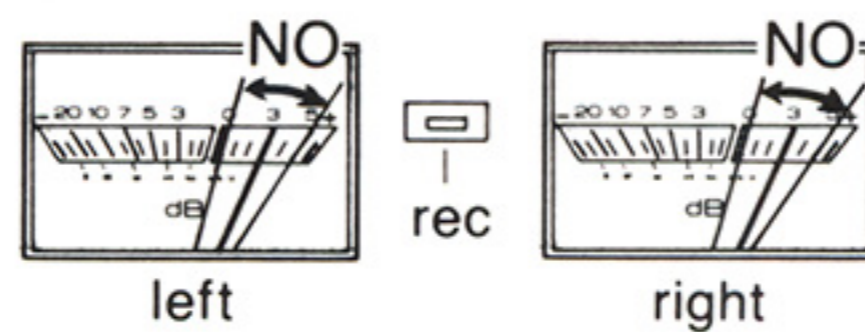

If, on the other hand, the indication needles continuously fluctuate as shown in this figure, especially if they move completely to the right, the recorded sound will be distorted.

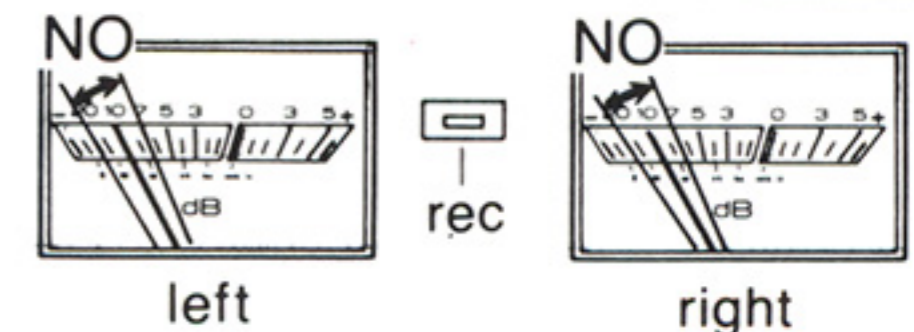

If the indication needles fluctuate only within the area shown in the figure, the recording will be noisy (the signal-to-noise ratio will be poor).

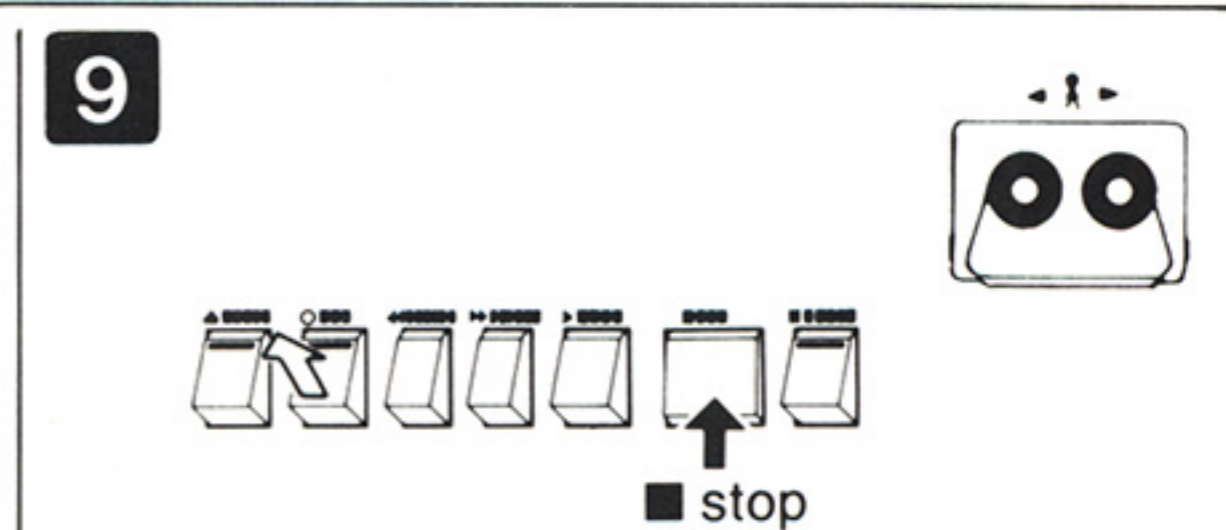
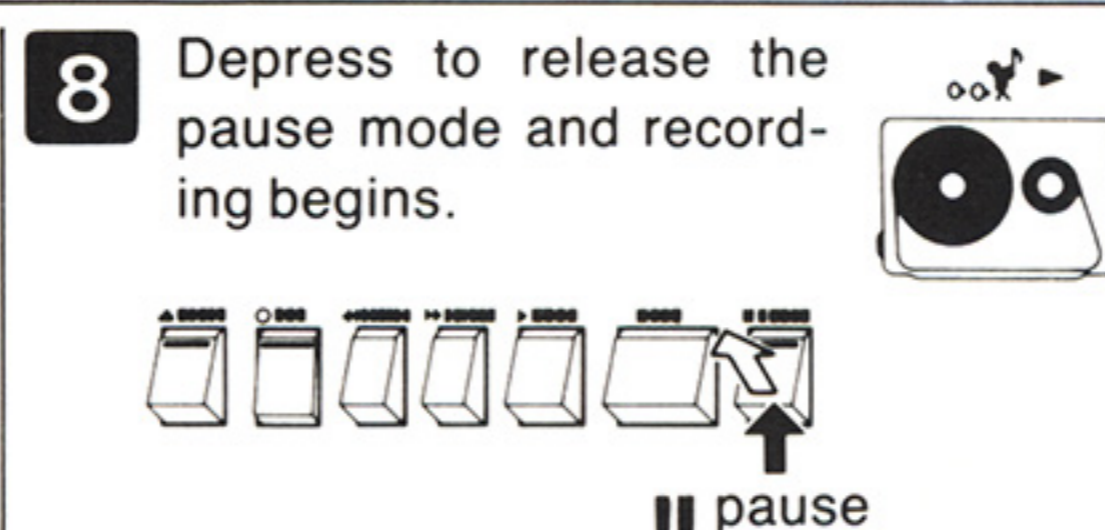
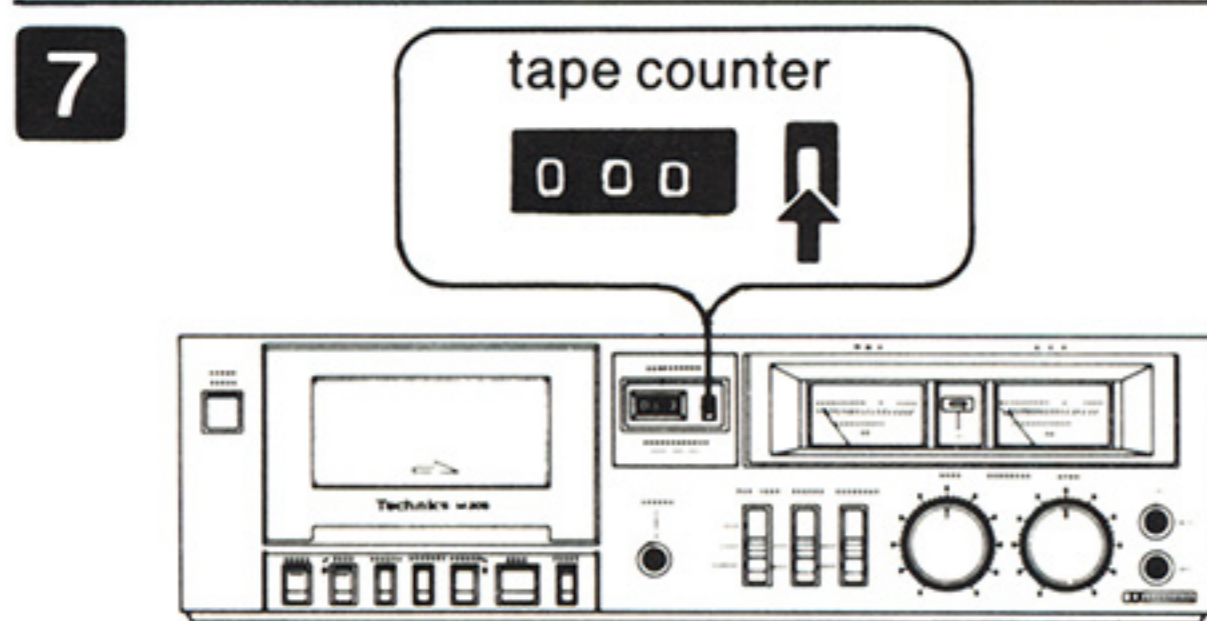

Notes:

• Be sure to use a cassette which has the two plastic tabs intact. If these tabs have been removed, a recording cannot be made. (Refer to "ACCIDENTAL-ERASE PREVENTION," on page 1.)

• Some audio material is copyrighted, and recordings of such material must be limited to personal use and enjoyment.
• Do not depress the Play Button since this unit is set to the recording mode when only the Record Button is depressed.

TIMER RECORDING AND PLAYBACK • Follow the numbered order.

•Connections to the power source

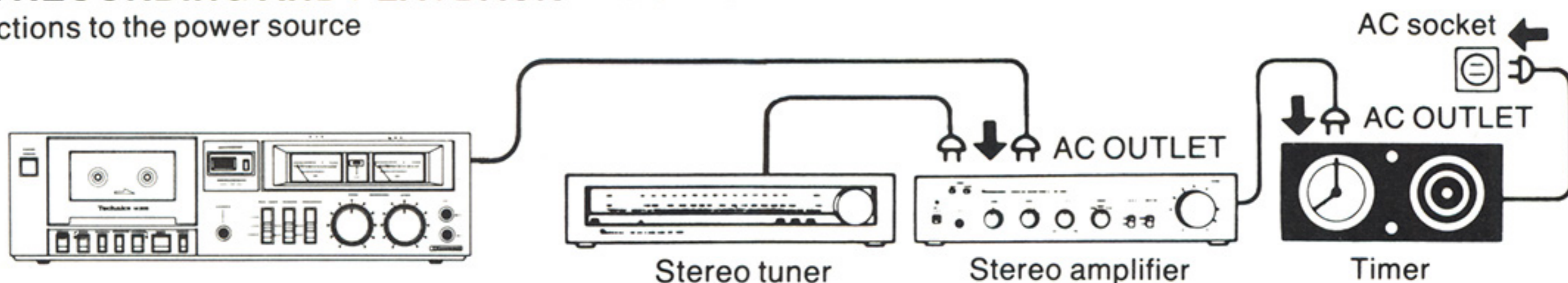

Recording with a Timer (Timer recording of FM broadcasts)

| | | | |
|--|--|--|--|
| <p>1 power push on</p> | <p>2 Refer to "CASSETTE INSERTION AND REMOVAL." on page 3.</p> | <p>3 Refer to page 1.</p> | <p>4 input select line mic</p> |
| <p>5 Select desired radio station.</p> <p>Tuning</p> | <p>6</p> <p> pause</p> | <p>7</p> <p>○ rec</p> | <p>8 left input level right</p> |
| <p>9</p> <p>■ stop</p> <p>Depress the Stop Button to release the Play Button.</p> | <p>10</p> <p> pause</p> <p>Depress to release the pause mode.</p> | <p>11</p> <p>Timer</p> <p>Set the timer to the desired time. (Depending upon the type of timer, the power to the amplifier, tape deck and tuner will then be turned off.) Refer to the operating instructions of the timer for further information.</p> | <p>12</p> <p>○ rec</p> <p>This completes the preparations for timer recording. At the desired time, the power will be turned on and the timer recording will begin.</p> |

Playback with a Timer

| | | | |
|---|--|--|-------------------------------|
| <p>1 power push on</p> | <p>2</p> <p>Refer to "CASSETTE INSERTION AND REMOVAL." on page 3.</p> | <p>3</p> <p>▶ play</p> | |
| <p>4</p> <p>Stereo amplifier</p> | <p>5</p> <p>■ stop</p> | <p>6 Rewind the tape of the position from which the timer playback is to begin.</p> <p>◀◀ rew/rev</p> | <p>7</p> <p>■ stop</p> |
| <p>8</p> <p>Timer</p> <p>Set the timer to the desired time. (Depending upon the type of timer, the power to the amplifier, tape deck and tuner will then be turned off.) Refer to the operating instructions of the timer for further information.</p> | <p>9</p> <p>▶ play</p> <p>This completes the preparations for timer playback. At the desired time, the power will be turned on and the timer playback will begin.</p> | | |

Notes:

- Mode selection for timer (recording or playback) should be made after the power is completely turned "OFF".
- If a timer mode selection change is desired (from recording to playback or viceversa), please make new selection starting from step No. 1 of the new mode as per our instructions.
- Do not make timer mode selection changes with the power "OFF" otherwise when the timer turns the unit on, there is a possibility that the wrong mode selection will be activated.
- Do not select the mode while turning the power "OFF".

MAINTENANCE • Follow the numbered order.

Cleaning the head section

Because the Head Assembly, Pinch Roller and the Capstan are in constant contact with the moving tape, dirt or residue from the tape on these parts will decrease the sound quality. They should be cleaned after every 10 hours of use, as described below:

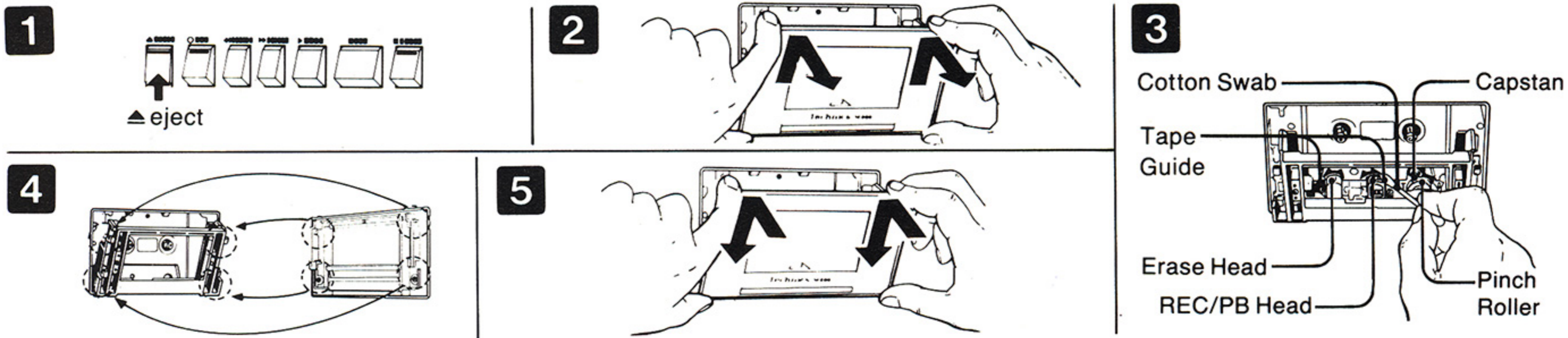

Notes:

1. If the Heads, Capstan or Pinch Roller are very dirty, apply a small amount of tape head cleaner to the Cotton Swab.
2. Don't allow magnetic materials, such as a Screwdriver or a magnet, near the Head Assembly.
3. When cleaning, be careful not to bend the Tape Guides.
4. Don't attempt to clean the cabinet with alcohol, benzine or thinner, because it may damage the finish. If the cabinet is dirty, clean with a soft cloth dampened with a soap-and-water solution.
5. Handle the window (removed to facilitate cleaning of the Heads) with care, because it might break if dropped.
6. When "Metal tape" is used, the Head Assembly should be cleaned after each 10 times of use.

IN CASE OF DIFFICULTY

If operation of this unit does not seem to be normal, check the following points before requesting service. If the trouble cannot be determined and corrected, contact the dealer from whom it was purchased, or an authorized Servicentre.

1. **After the tape cassette is inserted, the tape does not move when the Play button is pushed.**
 - Is the power cord correctly connected?
 - Is the Power switch pushed in to the "on" position?
2. **Although the tape moves, no sound is heard.**
 - Is the tape blank?
 - Are the connections of amplifier and speakers correct?
 - Are the connection cords from this unit to the amplifier correctly connected?
 - Is the volume control of the connected amplifier set to the correct position?
 - Is the monitor switch of the connected amplifier set to the correct position?
3. **Sound is distorted.**
 - Is the recording level too high?
 - Is the input impedance of the connected amplifier appropriate?
4. **The Record button cannot be pushed down.**
 - Is the tape cassette inserted correctly?
 - Have the recording-prevention tabs of the cassette been removed?
5. **Tape moves, but no sound can be recorded.**
 - Is the Input selector set to the incorrect position?
6. **Playback sound is hoarse or vibrates. Recorded sound is not clear.**
 - Are the head surfaces dirty?
 - Is foreign material adhered to the Pinch Roller and/or the Capstan?

In the unit is brought into a warm room after it has been in a very cold location (freezing temperature), it may not operate properly when first connected. This is due to condensation on internal parts of the unit. This effect will disappear. If it is allowed to stand for 30 minutes or so in a warm room before being used.

SPECIFICATIONS

| | |
|-------------------------------|--|
| Track System: | 4-track 2 channel stereo recording and playback |
| Tape Speed: | 4.8 cm/s (1 $\frac{7}{8}$ ") |
| Wow and Flutter: | 0.05% (WRMS) |
| Frequency Response: | Metal tape; 20~17,000 Hz CrO ₂ tape; 20~16,000 Hz Normal tape; 20~15,000 Hz |
| Signal-to-Noise Ratio: | Dolby NR in; 66 dB (above 5 kHz) Dolby NR out; 56 dB (signal level=max. recording level, CrO ₂ type tape) |
| Fast Forward and Rewind Time: | Approx. 90 seconds with C-60 cassette tape |
| Inputs: | MIC; sensitivity 0.25 mV, input impedance 60 k Ω applicable microphone impedance 400 Ω ~10 k Ω LINE; sensitivity 60 mV, input impedance 47 k Ω |
| Outputs: | LINE; output level 420 mV, output impedance 1.5 k Ω or less, load impedance 22 k Ω over HEADPHONES; output level 80 mV, load impedance 8 Ω |
| Bias Frequency: | 80 kHz |
| Head: | 2-head system 1-MX head for rec/playback 1-double-gap ferrite head for erasure |
| Power Requirements: | AC 120 V, 50~60 Hz |
| Power Consumption: | 10 W |
| Dimensions (W×H×D): | 43 cm×12.2 cm×20.6 cm (16 $\frac{7}{8}$ "×4 $\frac{13}{16}$ "×8 $\frac{1}{8}$ ") |
| Weight: | 3.9 kg (8 lbs 10 oz) |

Specifications are subject to change without notice.

*Noise reduction system manufactured under license from Dolby Laboratories.